

Hotel Key Card System
CLASSIC Version

Key Card Systems

by Messerschmitt®
Made in Germany

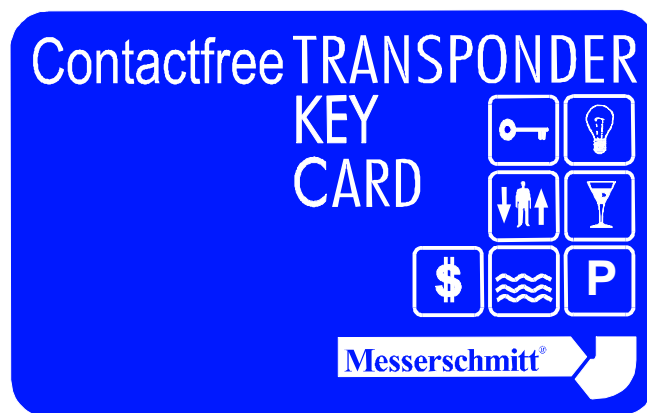

Contact Free Transponder Card

The very latest 13,56 MHz Technology (ISO)

Magnet Card System

Proven Technology



Locksmith Co., Ltd.
Email: sales@locksmith.co.th

Tel: +66 38 301 025
support@locksmith.co.th

Fax: +66 38 301 026
www.locksmith.co.th

Table of Contents		Page
1.	Messerschmitt	4
	The Hotel Automation Company	
1.1	Messerschmitt Product Range	6
1.2	Automation Benefits	7
1.3	Advantages at a Glance	8
2.	Overview CLASSIC System	10
2.1	Optional Card-Technologies	10
	☆ Transponder Card	
	☆ Magnet Card	
2.2	Contactfree Transponder Card System	11
2.3	Magnetic Card System	12
2.4	Reader Models, Installations Variations	13
2.5	What means "Off-line" and "On-line"	14
2.6	"On-Wall" Installation	15
2.7	Special Area Reader + Access Control Reader	16
	2.7.1 Special Area Reader	16
	2.7.2 Access Control Reader	16
2.8	Transponder Cash Card Reader	17
2.9	Key Card Encoder Unit	18
3.	Messerschmitt Hotel Security Locks	19
3.1	Exclusive Automatic Security Lock	19
4.	Card-Hierarchies	20
5.	System Benefits / Extensions	23
6.	System Handling and Functions	24
7	Installation, Remote Support via Modem	26
7.1	Modem Hot-line	26
7.2	Installation Specifications	27
8.	INCOS Energy Control Functionality	28
☆	References	31
☆	Short Telefax Enquiry	33

Hotel Key Card System

CLASSIC Version

Messerschmitt

Hotel Automation Systems



Messerschmitt Germany Head Office

Experience, Know-how and Latest Technologies

Since about 20 years Messerschmitt is one of the leading manufacturer specialised in electronic Ident Card Systems, Access Control and Energy Control Systems.

More than 1,000 Companies and Hotels are working with Messerschmitt Systems world-wide.

One of the innovative development of Messerschmitt Systems is the “Contact Free Chip Card System” with RF (Radio Frequency) technology, which provides a maximum of security and comfort. Additionally, Messerschmitt presents its patented Automatic Minibar and integrable Energy Control Systems.

© Messerschmitt Systems® AG, Nuremberg, Germany

Internet: <http://www.messerschmitt.com>



Locksmith Co., Ltd.
Email: sales@locksmith.co.th

Tel: +66 38 301 025
support@locksmith.co.th

Fax: +66 38 301 026
www.locksmith.co.th

1 Messerschmitt

The Hotel Automation Company

Messerschmitt Systems is the only company to deliver both off-line and fully integrated online Key Card Systems with Energy Save Automation. As manufacturer and designer of both hard- and software, Messerschmitt Systems has extensive experience in producing state of the art, latest technology to meet the demands of the modern hotel industry.

Distribution, customised delivery and installation are managed directly from our own factory, a guarantee for fair and attractive prices.

Local installation and service are managed exclusively by Authorised Messerschmitt Business Partners world-wide.



One of the innovative developments of Messerschmitt Systems is the "Contact Free Chip Card System", based on RF (Radio Frequency) technology on a 13.56 MHz basis.

This system provides a maximum of both security and comfort and can further be used as a Customer Loyalty Card or an Inhouse Credit/Debit Card. The system is also compatible to the existing patented Automatic Minibar and the integrated Energy Control System.

The Transponder Card combines the most easy handling and highest security available for your guests, staff and management.

Radio Frequency Technology is rapidly advancing as the standard choice for modern security systems today

As a premiere, this brand-new 13.56 MHz technology has been established a world-wide ISO standardisation. The IATA (Airline Association) is promoting its world-wide use as are UPS, DHL and the US Mail. This represents a world-wide break-through using this relatively new technology.

Messerschmitt Products

Hotel Automation Systems

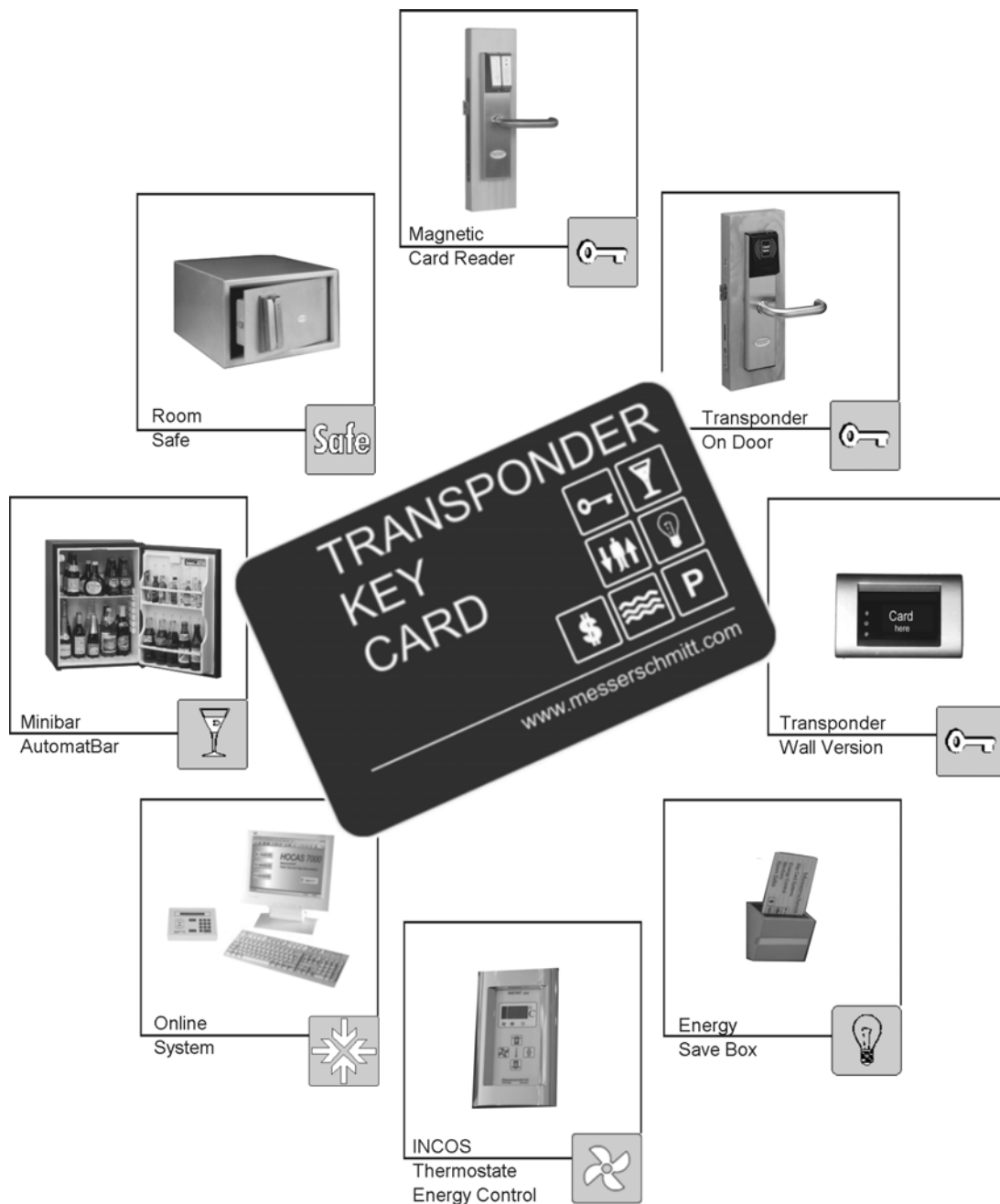

1.1 Messerschmitt Product Range "Multifunctional Systems" with only "1Card"

Hence every single Messerschmitt module provides full compatibility,
any on-line structure can be created to fulfil the customer's needs.



Contactfree Transponder Card System



Magnetic Card System



Minibars

- Option:
- Opening control/display
 - User access control with electronic lock

Automatic Minibars

- Automated Billing



Electronic Safes

- Usage Options:
- PIN Code access
 - Key Card or Credit Card access
 - Transponder Card access

1.2 Automation Benefits

Fully Integrated Hotel Card System & Energy Control System

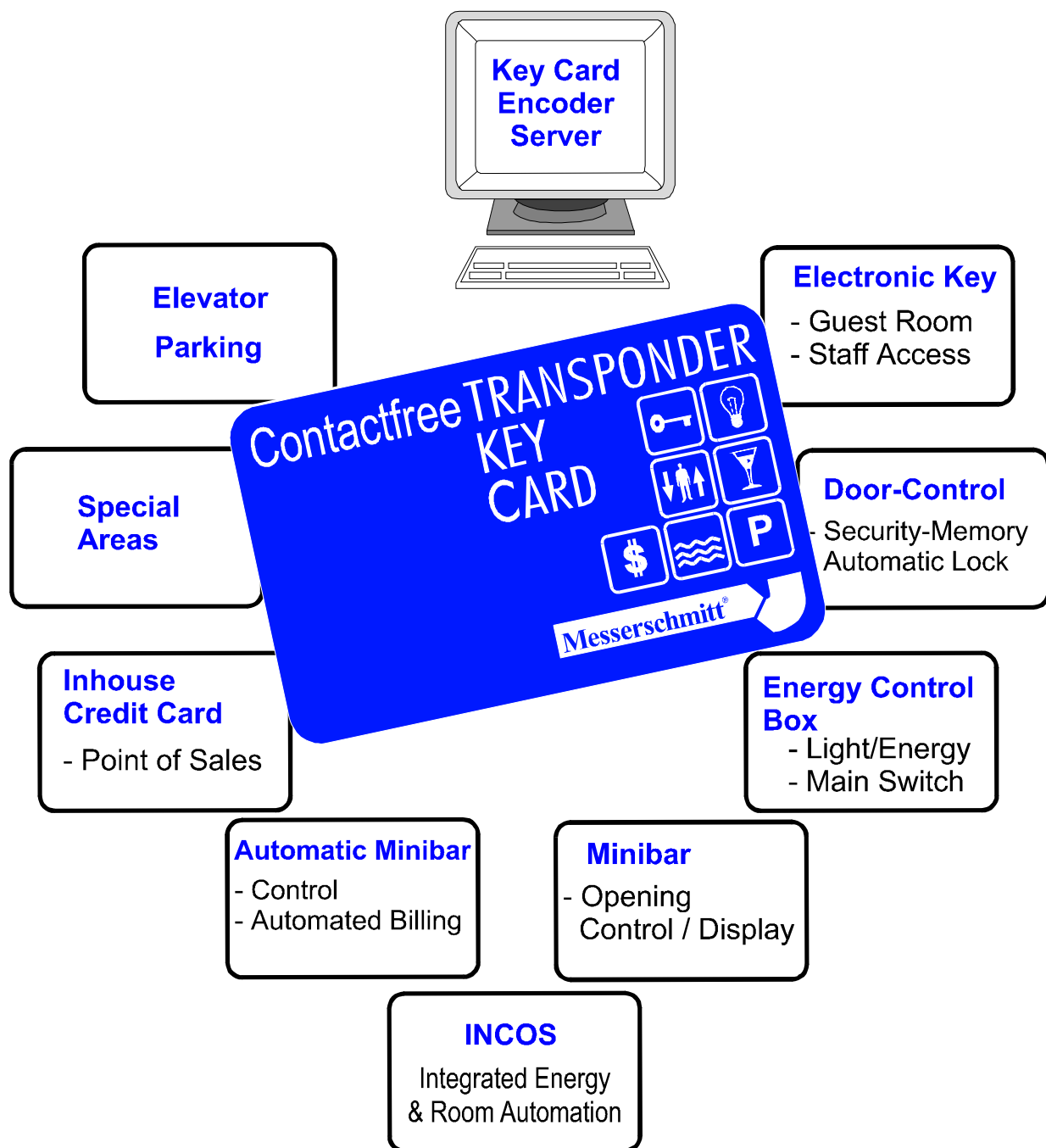

1.3 Advantages at a Glance

The Classic System is an autonomous off-line system using either traditional magnetic-strip cards or the latest contact free Transponder cards. The Classic System is usually installed as an on-door system.

The Classic System offers ease of use for both Guests and Hotel Staff with instant individual creation of Key Cards at Check-In.

The Classic System means the following advantages:

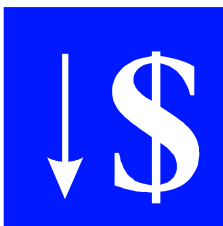

Up to 20 % reduced Investment Cost



by using Messerschmitt Modules



Easy and Quick Upgrade from conventional Systems



Customised System Packages



Installation Guides for Upgrading



Highest Security Standards

Lost or not returned Key Cards are automatically cancelled at departure date or creation of a new Key Card.

High Security against manipulation by security pre-coding with system ID and checksum control



Security Memory for Lock Interrogation Hand Held Terminal read-out

Each Reader is fitted with a standard memory which enables interrogation of the last 400 entries such as:



Which Guest / Which Staff Card



Date, time, and door

1.3 Advantages at a Glance



Interface to PMS Computer Systems

Supported Systems: Fidelio, HIS, Hogatex, Protel, INTRAC.

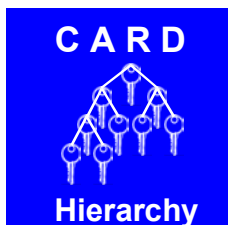

Special Areas, Access Control

Up to 40 additional Special Areas e.g. Storerooms, night entrance, parking area, elevators, staff access, etc. These configurable areas are in addition to the standard 11 available hierarchies for key cards.



Quick and simple installation

Reader integrated batteries for approx. 10.000 entries or approx. 2 years
No power cables necessary

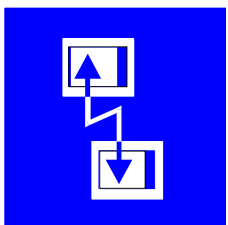

Support via Modem Hot-line

Central Hot-line support and maintenance with Remote Support Modem Software, transfer of new software releases and software updates

2 Overview Classic System

2.1 Optional Card – Technologies

Two different Key Card technologies are available:

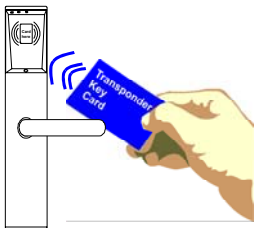

Contact Free Transponder Technology

Combines the very latest in access control technology – with extreme ease of use.

Messerschmitt Systems offers unique upgrade opportunities whereby the installed technology can be upgraded with minimal installation efforts. For example, Magnetic stripe technology can be easily upgraded to the new transponder technology.

This is possible because of the modular construction of the Messerschmitt components.

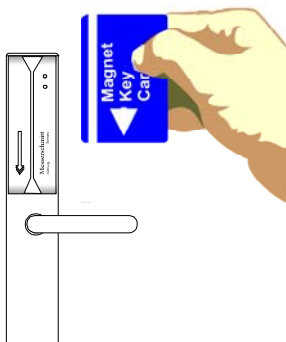

Magnetic Stripe Technology

World-wide acceptance and installations, proven technology.

2.2 Contactfree Transponder Card System

Standard System Components On-Door:

- 1 On-Door Transponder Card Reader*
- 2 High security escutcheons with handles stainless steel
Available Finishes : Brushed Stainless Steel
Polished or Satin Brass
Polished Stainless Steel (like Chrome)
- 3 Server & Card Encoder for Key Card Coding

Options:

- 4 Hotel High Security (Automatic) Lock
- 5 Interface to Hotel PMS (Front Office System)
- 6 **brand-new** DIN/EN compliant fire-rated escutcheons and DIN/EN lock-case

* Readers are also available for “wall-mounting” (flush or surface mounted), cf. Page 16.

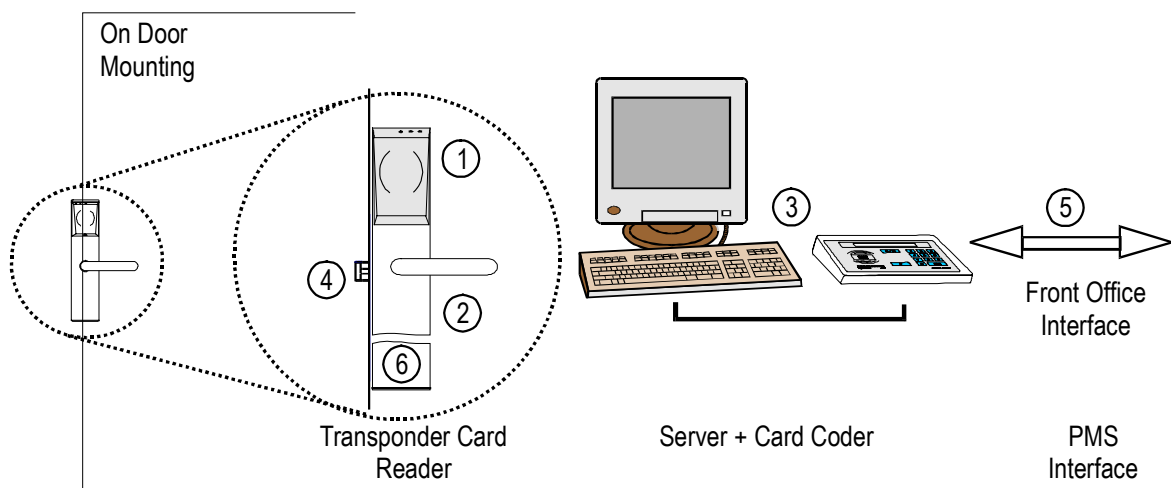

2.3 Magnetic Card System

Standard System Components On-Door:

- 1 On-Door Magnetic Card Reader*
- 2 High security escutcheons with handles stainless steel
Available Finishes : Brushed Stainless Steel
 Polished or Satin Brass
 Polished Stainless Steel (like Chrome)
- 3 Server & Card Encoder for Key Card Coding

Options:

- 4 Hotel High Security (Automatic) Lock
- 5 Interface to Hotel PMS (Front Office System)
- 6 **brand-new** DIN/EN compliant fire-rated escutcheons and DIN/EN lock-case

* Readers are also available for "wall-mounting" (flush or surface mounted), cf. Page 16

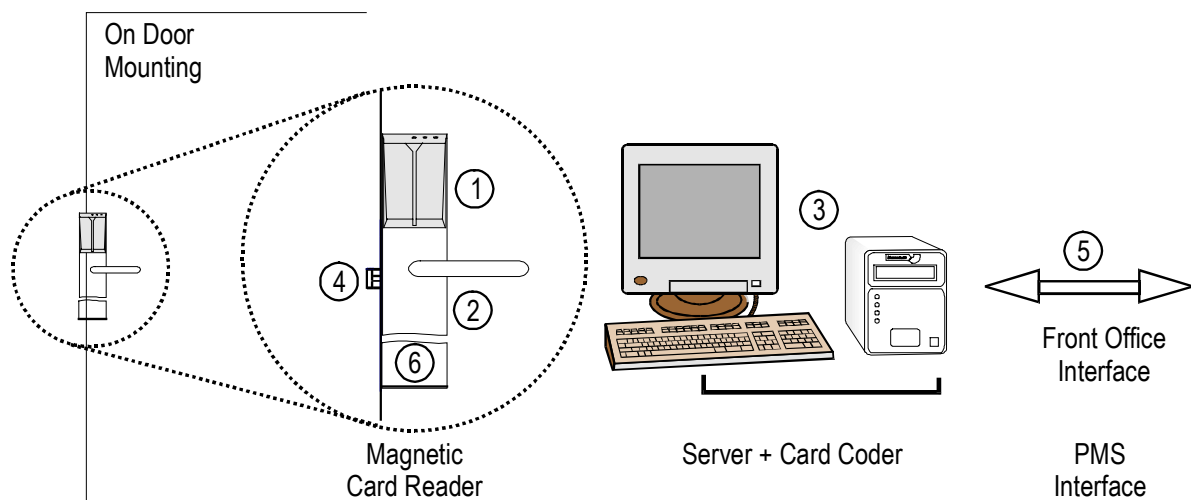

2.4

Models

Reader Installation-Variations

The off-line readers can be installed both as "On-door Models" (battery operated), or as "On-Wall Models" with centralised mains power supply per floor.

Installation On Door

Magnetic Card Reader

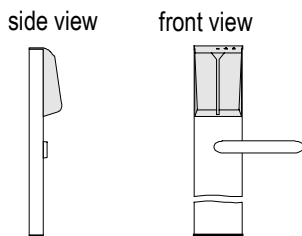

280x65x45

Transponder Card Reader

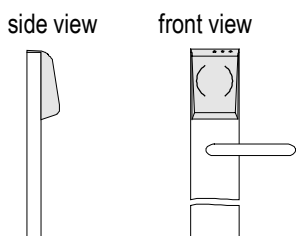

280x65x37 (HxWxD in mm)

The off-line reader system is supplied with battery packages. For on-line operation the readers are supplied with power supply and are connected to a ringbus. The wiring for the ringbus is installed with a cable bridge through the door.

Installation On Wall

Magnetic Reader

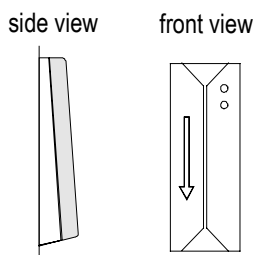

150x53x40

Transponder Reader

surface mounted on wall

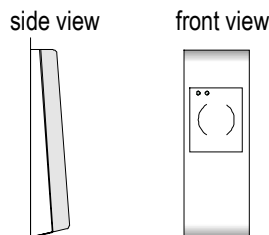

150x53x40

flush mounted

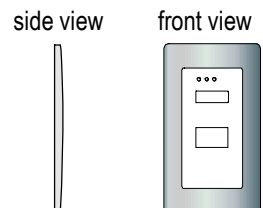

140x80x10

2.5 What means "Off-line" and what means "On-line"

The CLASSIC system works off-line.

Each reader is working autonomously without any connection to a central unit. Nearly 90% of all installed systems work off-line.

The EXECUTIVE system works on-line.

Each reader is connected via a bus network to the central system PC at the reception. The on-line functionality guarantees high security, automation, automatic energy control, Credit Card Functionality of the Transponder Card for the automation of payments.

2.6 On-Wall Installation

Optionally, readers can be mounted on-wall.
This allows free selection of custom escutcheons and locks or (in case of refurbishment) keeping the existing escutcheons.
Two installation versions of on-wall readers are available:

- a.) **Flush mounted** installation for Transponder Card readers
- b.) **Surface mounted** installation for Magnetic Card readers

System Components On-Wall:

- 1 Wall mounted Card Reader controls electronic door release (striker plate)
- 2 Electronic Door release (provided on site)
- 3 System Server & Card Encoder for Key Card Coding
- 4 Interface to Hotel PMS (Front Office System)

Additional Optional Extras:

- 5 **brand-new** DIN/EN compliant fire-proof escutcheons
- 6 On-line connection to ring bus

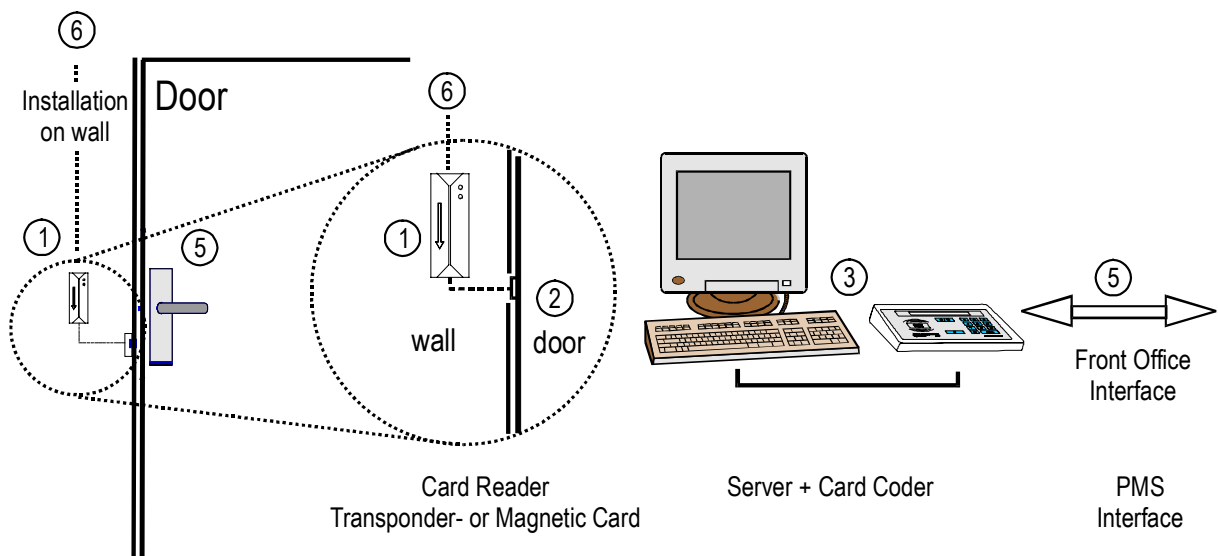

2.7 Special Areas or Common Areas Access Control Reader

In Addition to the conventional Guest Room Reader models, the following Readers with specific software controlled functionality are available:

2.7.1 Special Area Reader or "Common Areas"

Used in general access areas for guests and staff
e. g. for the following areas:

- ➔ **Elevator Access,
Specific Floor Access**
- ➔ **Restricted free of charge access
e.g. Fitness area**
- ➔ **Minibar User Access**

2.7.2 Access Control Reader

Staff Key Cards can be defined for specific time limited access.
These Readers are individually configurable for room and time zones

- ➔ **Staff Office Access, Back Office Access**
- ➔ **Storerooms, Staff Entrances, etc.**
- ➔ **Main and Side Entrances**

2.8 Transponder Cash Card Reader

The Transponder card is the ideal medium for automatic payment systems. The card is charged or loaded upon pre-payment for use within the Hotel.

Alternatively, the card can also be used as an in-house Credit Card with online accounting directly to the guest account within the Front Office PMS System. In this instance the Key Card Reader is directly attached to the POS System.

Transponder Cash Card Reader Uses

The Transponder Card is an ideal automation method for chargeable guest services. The Card can be used for the following services:



Wellness Centre

Sauna, Fitness area,
Swimming Pool.

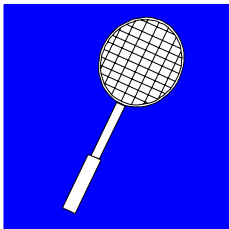

Sport Facilities

Tennis, Squash,
Bowling, etc.

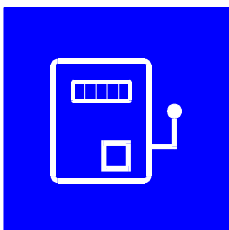

Gaming Machines

Billiards, Darts, etc.



Direct POS connectivity

Cashiers, as e.g. Micros, Schultes, Gastrofix.
Vending machines, as e. g. Wurlitzer, Mars, Coca-Cola.

2.9 Key Card Coder Unit

Key Card issuing at Check-In

Key Card Encoder handling at Check-In is quick and easy with the Windows 98/NT/2000 based user interface. Up to 8 (16) coding stations can be operated simultaneously using the encoder network.

For security purpose, all encoder transactions are recorded in a log file. The encoder stations are equipped with displays providing operational guidance and can be used for card identification and verification.

Key Card encoding Possibilities:

1. Direct encoding at the Messerschmitt System PC
2. Direct integration to the PMS Check-In Terminal

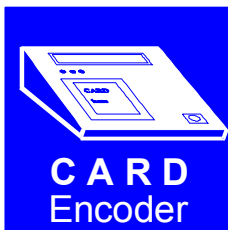

1. Encoding with the Messerschmitt System Server

At Check-In, the room number and duration of stay are entered. All other data is automatically generated by the System PC. The Key Card is issued and ready for use in seconds.



2. Encoding via the PMS Check-In Terminal

This is the fastest and most elegant method of issuing Key Cards. All necessary data is generated from the Check-In terminal and automatically transferred to the coding station. This encoding method requires an interface between the Front Office PMS System (Host) and the Messerschmitt System PC.

A Messerschmitt standard interface program for most Front Office Systems is available.

3 Messerschmitt Hotel Security Locks

3.1 Exclusive Automatic Security Lock

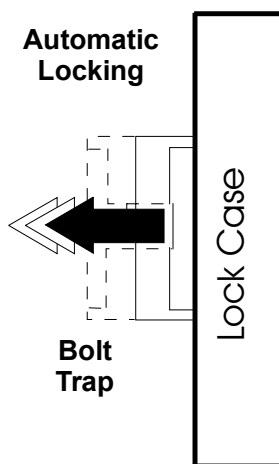

Whenever the door is closed, upon entering or leaving a room, the latch is automatically extent by 20 mm locking the door. As such, the door is always locked. Through the integration of an auxiliary dead bolt, latch manipulation is impossible, providing maximum security.

The door can only be opened from the outside with a valid Key Card. In locked status, the door handle can be freely moved without engaging the lock, this prevents material strains. Access is only possible with a valid Key Card. Emergency Access due to mechanical failure is possible for hotel staff.

For Guest security, the door can be opened at any time from inside the room using the door handle. This **Anti-Panic Function** is a standard feature of the system

The Automatic Security Lock guarantees unique mechanical security for both Guests and Hotel Management.



Electronic „Do Not Disturb“ or „Privacy“ functionality.

The electronic „Do Not Disturb“ function is activated on the inside escutcheon. When activated, the door can only be opened with a Guest Card or the emergency card. All other cards, including steward and manager cards will have access denied.

Card-Hierarchies and Card Types

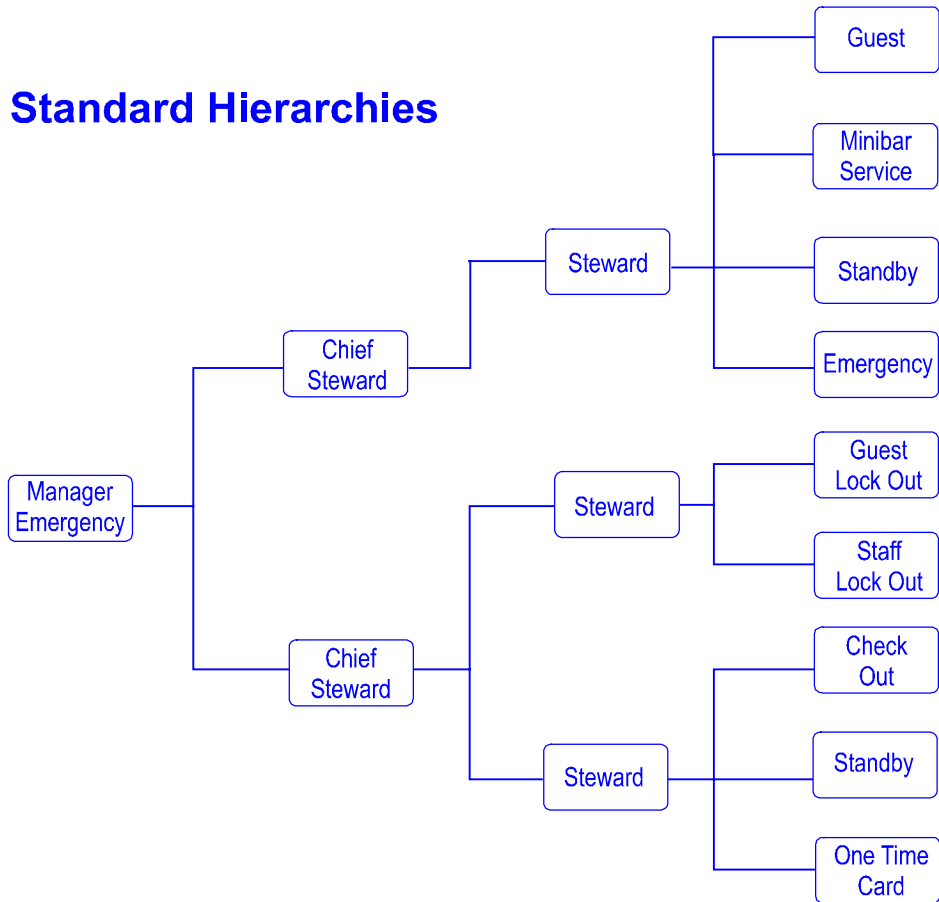

Additional up to 40 free configurable specific access areas

Sample configuration:



4. Card-Hierarchies and Card Types

The Messerschmitt Card Coder software is configurable for 11 hierarchical levels and an additional 40 special areas:

Guest Card	Coded for a specified date and time period for access to a specific room and / or pre-defined special areas (e.g. sauna, garage, night entrance, etc.)
Steward Card	Coded for a specified number of rooms (e.g. floor or wing.)
Chief Steward Card	Coded like a Steward Card, but with general access to multiple floors or wings
Manager Card	Access to all rooms and / or special areas
Emergency Card	Access authority identical to Manager Card with additional access to locked "Do Not Disturb" doors.
One-Time Card	One-Time-Access for a specific door for service purpose (e.g. technical maintenance, flower service, etc.)

4. Card Hierarchies / Card Types

Standby Card

Emergency back-up for guest cards to be used in case of Coding Unit failure at reception. A Standby Card is prepared for each room at system set-up.

Minibar Card

Card for minibar service staff only.

Guest Lock-Out Card

This card is to preventing guest access to a specific room and contact the Hotel Reception.

Check-Out Card

Service Staff Card for departure day usage
Use of this card invalidates the current guest card.

Staff Lock-Out Card

Access denial for all staff cards
(e.g. seal a room after a crime.)

"Special Area" Card

The configuration of up to 40 special areas enables the internal organisation of specific access areas such as: Offices, storerooms, sauna, fitness centre, garage, elevators, Executive Floors, etc.

